

Changing the line on Easyrig VARIO 5

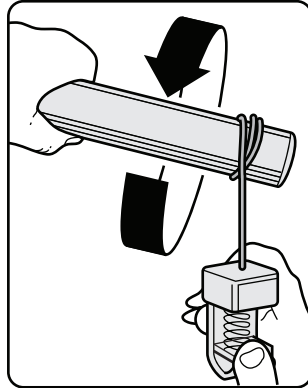

1. Put the Vario on minimum load. Extend the suspension line and hold it there by winding it around the support arm to release the tension.

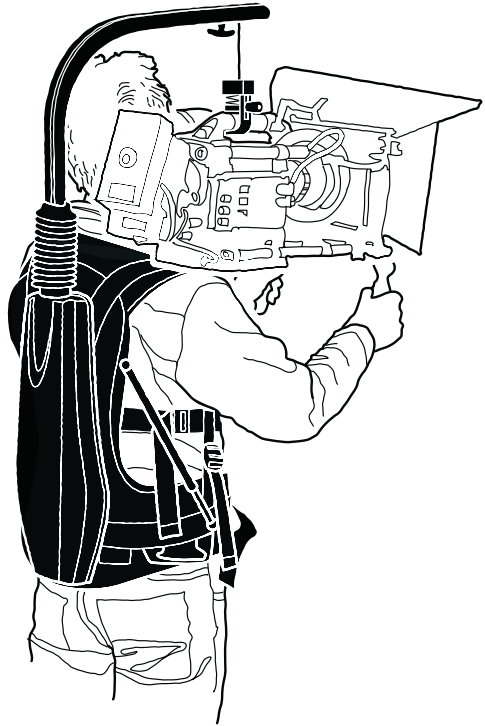
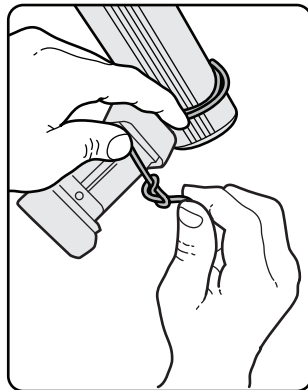

2. Detach the camera hook by untying the knot and let the line go out through the upper arm.

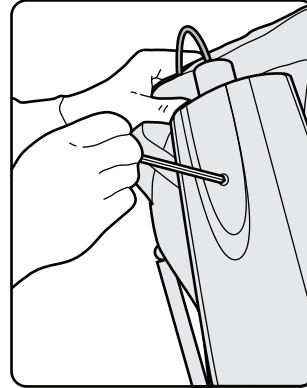

3. Remove the plastic cover by releasing the screws on the back.

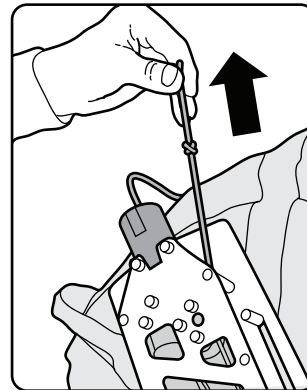

4. Remove the old line.

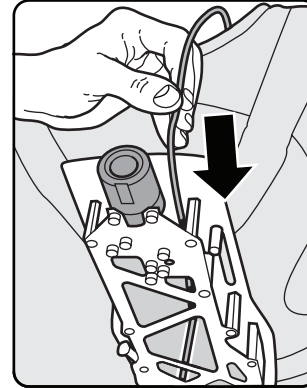

5. Start with the new line through the small plastic hole at the top of the unit.

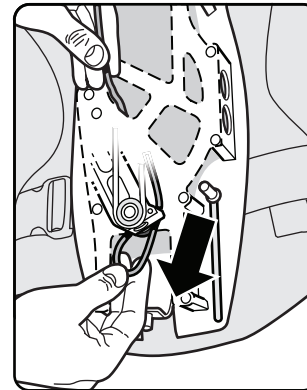

6. Let the line pass through the inner bottom red wheel and up.

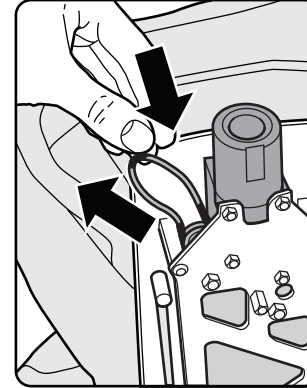

7. The line will go around the red top wheel on the left side and then down.

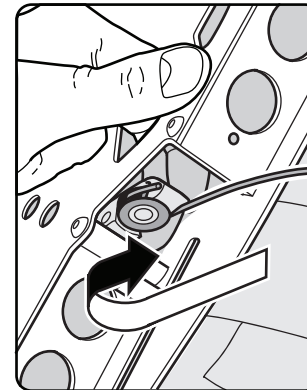

8. The line will pass the middle blue wheel at the bottom and up.

Vario 5

Easyrig

Designed and made in Sweden
www.easyrig.com

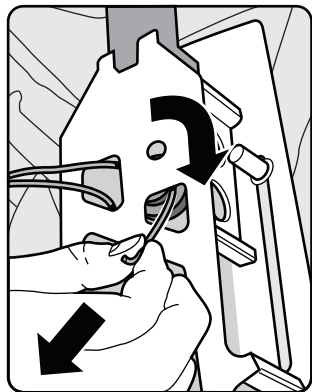

9.
The line will go around the red wheel on the right side at the top and then down.

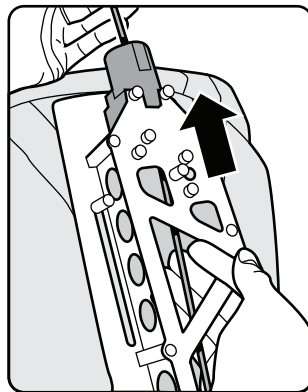

11.
Finally you will lead the line through the big black steering wheel and out where the tube is mounted.

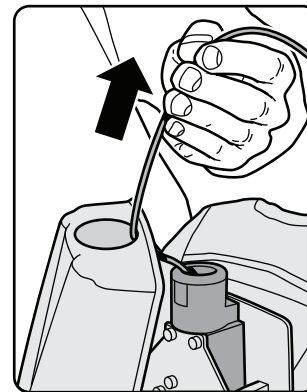

13.
Lead the line through the big hole in the cover and re-mount the plastic cover.

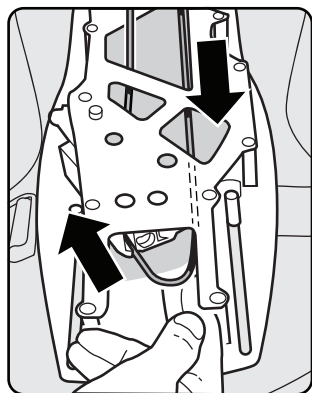

10.
The line will pass the outer bottom red wheel and then up.

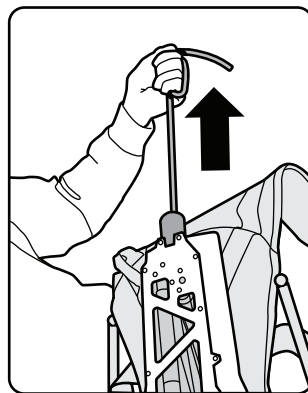

12.
Check if the Vario 5 power pack is working properly.

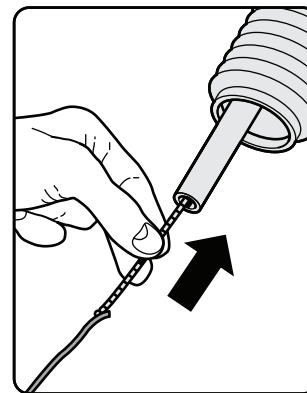

14.
Connect the line to the special threading tool and pull it up through the lower tube and over the wheels inside the upper support arm.

IMPORTANT!

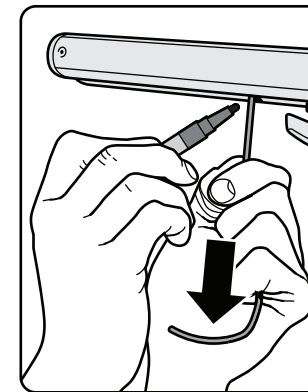

15.
When marking the line, it is important to pull it down an additional 5cm (2 inches). Thread the line through the camera hook and make a knot on the mark.

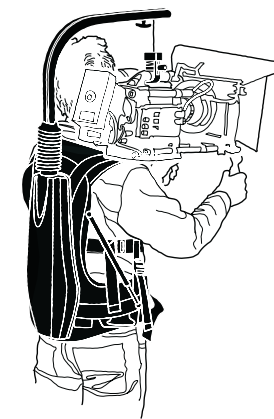

Good luck from the
inventor of Easyrig
Johan Hellsten